

WHAT'S IN THE BOX

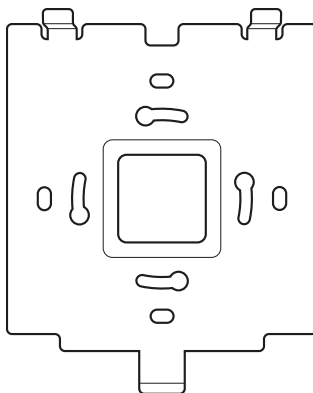

IMPORTANT

- Download the latest CP100 Owner's manual from the Manuals/Downloads tab of www.bluesoundprofessional.com/product/CP100
- Visit support.bluesound.com for further information and assistance about getting the most out of your CP100.

INSTALL

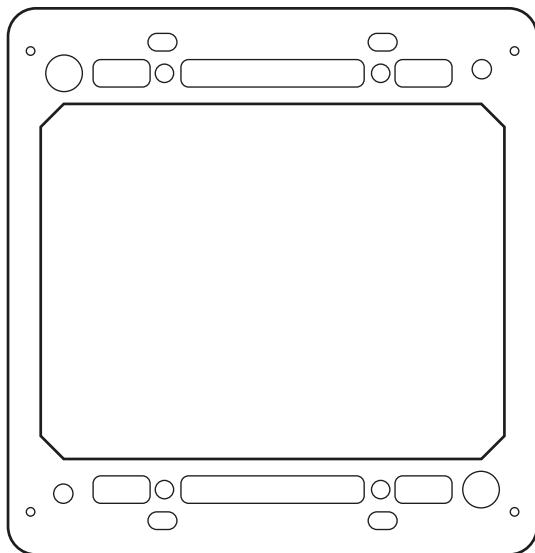
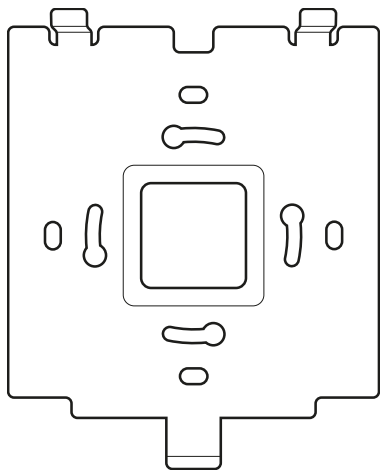

Use compatible screws to install bracket to an in-wall low voltage box (not supplied).

CONNECT AND POWER UP

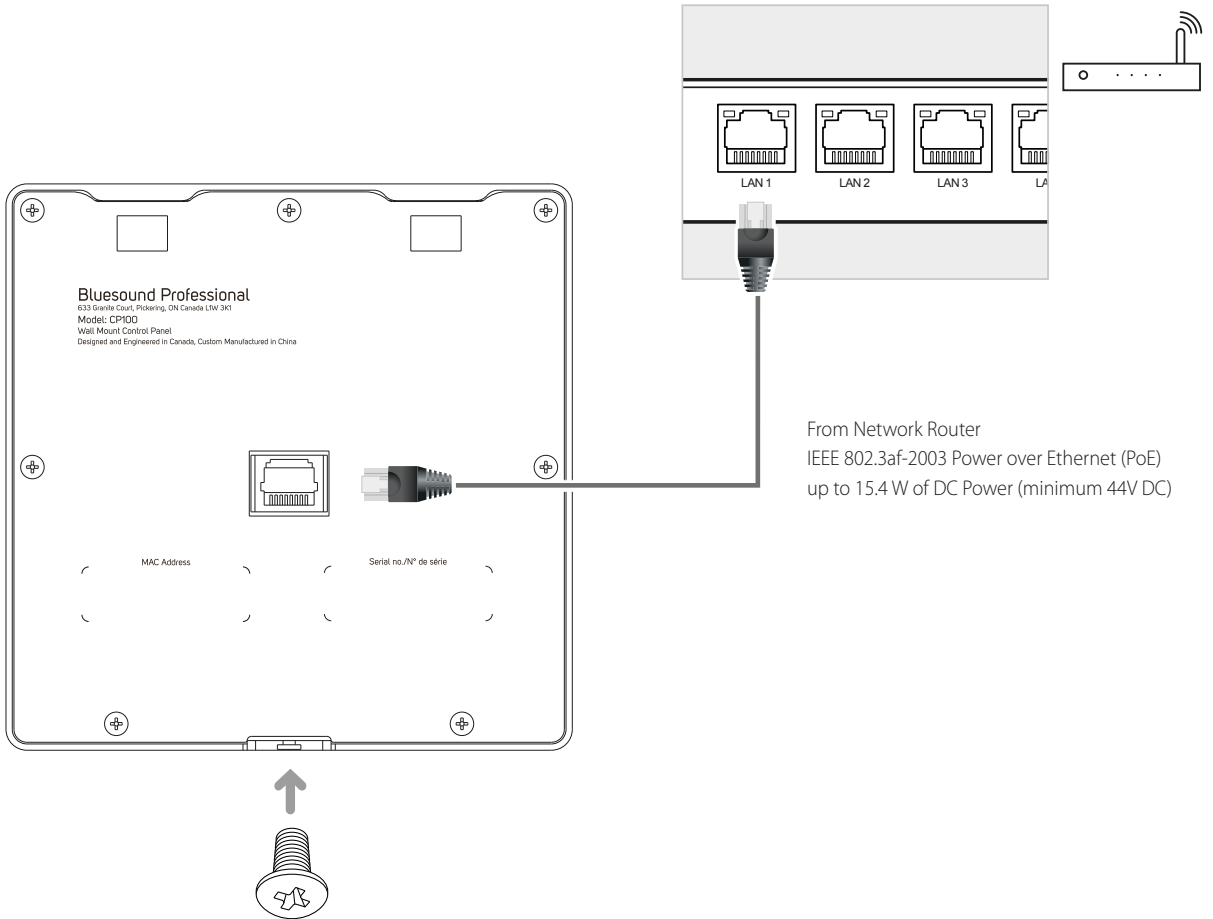

Slot-in Control Panel to the bracket, secure with screw and connect Ethernet cable (not supplied).

DOWNLOAD

BluOS INTEGRATION UTILITY APP

BluOS Integration Utility App for Windows or macOS is available for download from www.bluesoundprofessional.com/product/CP100
Launch BluOS Integration Utility App. Refer to CP100 owner's manual on how to configure the Control Panel.

©2020 BLUESOUND PROFESSIONAL, A DIVISION OF LENBROOK INDUSTRIES LIMITED

All rights reserved. Bluesound and Bluesound logo are trademarks of Bluesound Professional, a division of Lenbrook Industries Limited.
No part of this publication may be reproduced, stored or transmitted in any form without the written permission of Bluesound Professional.
CP100-QS-EN-V04 - MAY 2020